

AS PROPOSED SECOND FLOOR PLAN  
(Scale 1:50)

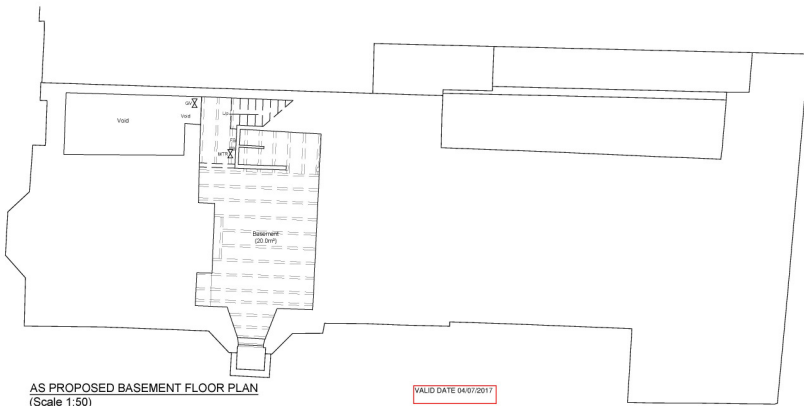

AS PROPOSED BASEMENT FLOOR PLAN  
(Scale 1:50)

VALID DATE 04/09/2017

THIS COPY HAS BEEN MADE BY OR WITH THE AUTHORITY OF BREDALE DISTRICT COUNCIL PURSUANT TO SECTION 41 OF THE COPYRIGHT DESIGN AND PATENTS ACT 1988. UNLESS THAT ACT PROVIDES A RELEVANT EXCEPTION TO COPYRIGHT, THE COPY MADE MUST BE CORDED WITHOUT THE PRIOR PERMISSION OF THE COPYRIGHT OWNER.

© Prospect Design Architectural Services

**Notes**  
Do not scale from this drawing or consider any dimension to be accurate.  
In the event of any discrepancy being found, these should be brought to the attention of the Prospect Design for further instruction.  
This drawing is for Planning purposes only and is not to be considered a consultation or setting out drawing.  
North Point shown approximately.  
The proposed layouts are subject to the following, although not exhaustive:  
1. Structural Engineers Requirements.  
2. Mechanical and Electrical Engineers Requirements.  
3. Drainage Requirements.  
4. Planning Approvals.  
5. Building Regulations approvals.

DATE: 04/09/2017  
DRAWN BY: MR & MRS HANAGAN  
CHECKED BY: MR & MRS HANAGAN

**PROSPECT DESIGN**  
Architectural Services  
54 Hennings, Malton, N. Yorks. YO17 7JF  
Tel: 01937 892272 Mob: 07792700035  
Email: info@prospectdesign.co.uk web: www.prospectdesign.co.uk

Client: MR & MRS HANAGAN  
18 THE MOUNT  
MALTON  
YO17 7ND

Job Title: ALTERATIONS TO 18 THE MOUNT,  
MALTON

Drawing Title: AS PROPOSED BASEMENT  
AND SECOND FLOOR PLANS

Scale: 1:50 @ A1 Drawn: R.W.  
Date: 13.06.2017 Checked: ...

Drawing Number: PD230-05